

Type	
Project	
Notes	

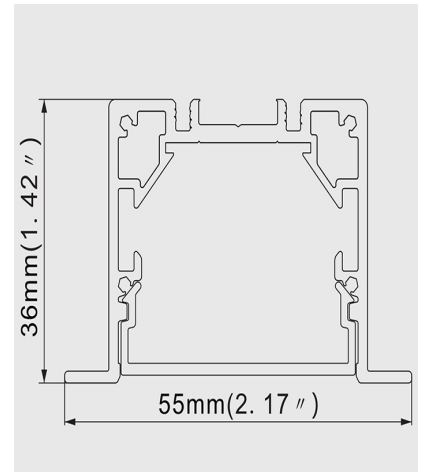

Linear Luminaire - R5536

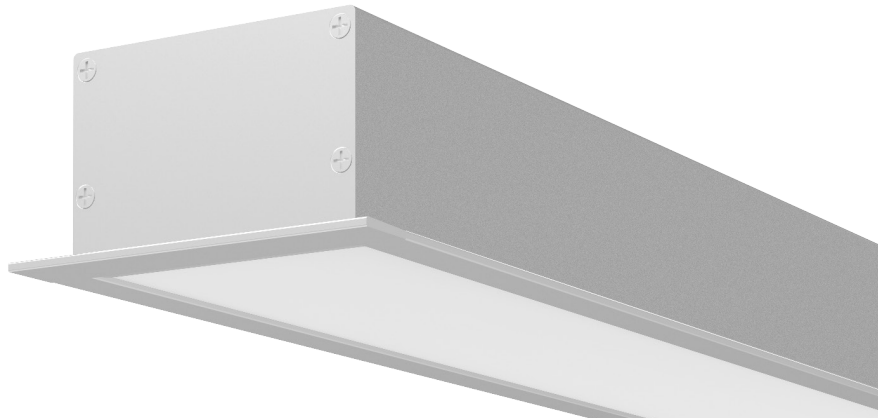

## PRODUCT SPECIFICATIONS

Model	R5536
Length	1200mm or 2500mm
Lumen Output	100 lm/W or 90 lm/W
CRI	80 or 90
Voltage	100 - 277V AC 347V AC
Colour Temperature	3000k 3500k 4000k 5000k RGBW
Installation	Recessed
Beam Angle	90 (PDM) or 65 (UGR < 19)
Certification	cETLus, CE, RoHS
Warranty	5 years

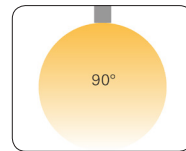

PDM Cover

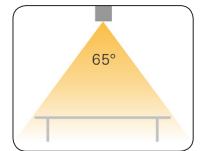

UGR<19 Cover



## ORDER FORM

R5536					R					
1	2	3	4	5	6	7	8	9	OPTIONS	

1. FAMILY	2. SIZE	3. OUTPUT LEVEL	CRI*	4. VOLTAGE
R5536	<b>12</b> 1200mm	<b>A</b> 600 lm @ 6 W / ft	<b>80</b>	<b>27</b> 100 - 277V AC
	<b>25</b> 2500mm	<b>B</b> 1000 lm @ 10 W / ft	<b>80</b>	<b>34</b> 347V AC
		<b>C</b> 540 lm @ 6 W / ft	<b>90</b>	
		<b>D</b> 900 lm @ 10 W / ft	<b>90</b>	

\*Lumen output and CRI have restricted corresponding values

5. CCT	6. INSTALLATION	7. COLOUR	8. DIMMING	9. LENS
<b>30</b> 3000K	<b>R</b> Recessed	<b>1</b> Silver	<b>1D</b> No Dimming	<b>90</b> PDM
<b>35</b> 3500K		<b>2</b> Black	<b>2D</b> 0-10V Dimming	<b>65</b> UGR<19
<b>40</b> 4000K		<b>3</b> White	<b>3D</b> TRIAC Dimming	
<b>50</b> 5000K			<b>4D</b> DMX	
<b>60</b> RGBW			<b>5D</b> Dali	
			<b>6D</b> Lutron Hi-Lume	

OPTIONS	CONNECTORS	MOUNTING
	<b>C1</b> R-5536-90L	<b>M1</b> R5536-BI
	<b>C2</b> R-5536-90W	<b>M2</b> L-SM
	<b>C3</b> R-5536-90N	
	<b>C4</b> R-5536-90T	
	<b>C5</b> R-5536-90X	
	<b>C6</b> R-180	

## OPTIONAL ACCESSORIES

### CONNECTORS

- C1** R-5536-90L
- C2** R-5536-90W
- C3** R-5536-90N
- C4** R-5536-90T
- C5** R-5536-90X
- C6** R-180

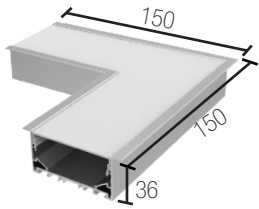

(L\*W\*H) 150\*150\*36 mm

C1

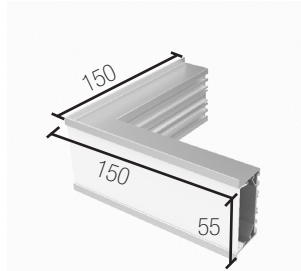

(L\*W\*H) 150\*150\*55 mm

C2

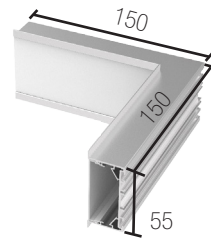

(L\*W\*H) 150\*150\*55 mm

C3

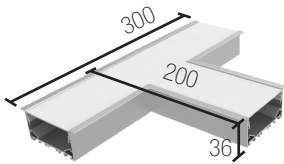

(L\*W\*H) 300\*200\*36 mm

C4

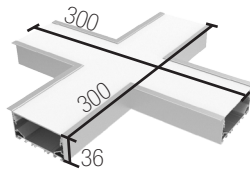

(L\*W\*H) 300\*300\*36 mm

C5

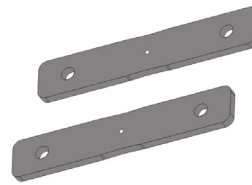

Connection bracket

C6

### MOUNTING

- M1** R5536-BI
- M2** L-SM



Recess mounting bracket <sup>M1</sup>

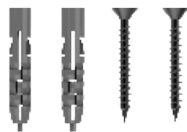

Mounting screws <sup>M2</sup>