

Type	
Project	
Notes	



PRODUCT SPECIFICATIONS

Summary	ADL-WUL-0901A
Lumen Output	1050 lm
Power Consumption	9 W
Dimensions (mm)	Ø 79 x 111
Voltage	24V DC
Colour Temperature	3000k, 4000k, 5000k
IP	67 or 68
Warranty	5 years

ADL-WUL Series

Aluminum Walkover Up-Light

For outdoor, recessed, path, decking

External driver - 2 metres of power cable

Professional optical lens

Weather resistant hard anodized finish

Glue-free or underwater versions



Frosted glass lens



Silk-screen glass lens

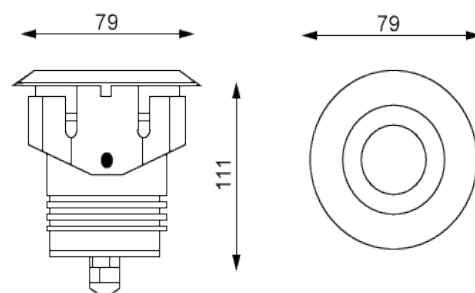

units in mm



Mounting sleeve

ORDER FORM

ADL-WUL-0901A					
1	2	3	4	5	6
I. FAMILY	2. BEAM ANGLE	3. CCT	4. IP	5. LENS OPTIONS	6. OPTIONS
ADL-WUL-0901A	38 38° (standard)	30 3000K	67	1 Frosted glass lens	Y Mounting Sleeve
	20 20°	40 4000K	68	2 Silk-screen glass lens	
	30 30°	50 5000K			