

Type	
Project	
Notes	



ADL-WUL Series

Aluminum Walkover Up-Light

- For outdoor, recessed, path, decking
- External driver - 2 metres of power cable
- Professional optical lens
- Weather resistant hard anodized finish
- Aluminum
- Waterproof and glue-free

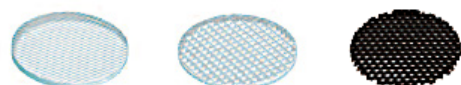

Linear glass lens Soften glass lens Honeycomb Louver

PRODUCT SPECIFICATIONS

Summary	ADL-WUL-0502A
Lumen Output	550 lm
Power Consumption	5 W
Dimensions (mm)	Ø 64 x 97
Voltage	24V DC
Colour Temperature	3000k, 4000k, 5000k
IP	67
Warranty	5 years

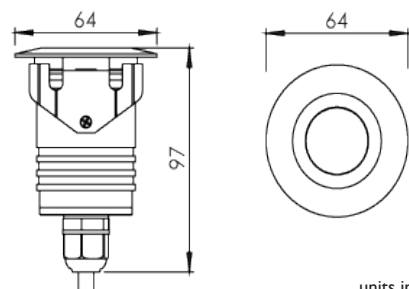

units in mm

ORDER FORM

ADL-WUL-0502A				
---------------	--	--	--	--

1

2

3

4

1. FAMILY

ADL-WUL-0502A

2. BEAM ANGLE

- 40** 40° (standard)
- 24** 24°
- 60** 60°

3. CCT

- 30** 3000K
- 40** 4000K
- 50** 5000K

4. LENS OPTIONS

- 1** Linear Glass lens
- 2** Soften Glass lens
- 3** Honeycomb Louver