

Type	
Project	
Notes	



ADL-UWL Series

Underwater Light

For pool, fountain, aquarium

External driver - 2 metres of power cable

U-shape bracket for adjustable angle

Stainless steel

High Molybdenum content corrosion resistant

Professional optical reflector



Left: Frosted glass lens

Right: Silk-screen glass lens

PRODUCT SPECIFICATIONS

Summary	ADL-UWL-0101A
Lumen Output	120 lm
Power Consumption	1 W
Dimensions (mm)	Ø 43 x 53
Voltage	12V DC
Colour Temperature	3000k, 4000k, 5000k, Red, Green, Blue
IP	68
Warranty	5 years

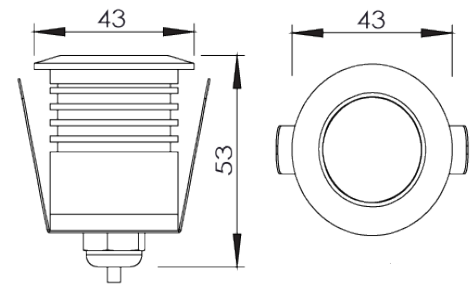

units in mm

ORDER FORM

ADL-UWL-0101A				
---------------	--	--	--	--

1

2

3

4

1. FAMILY

ADL-UWL-0101A

2. BEAM ANGLE

36 36° (standard)
21 21°

3. CCT

30 3000K
40 4000K
50 5000K
R Red
G Green
B Blue

4. LENS OPTIONS

1 Frosted glass lens
2 Silk-screen glass lens