

Type	
Project	
Notes	



ADL-WUL Series

Aluminum Walkover Up-Light

- For outdoor, recessed, path, decking
- External driver - 2M of power cable
- Professional optical lens
- Weather resistant hard anodized finish
- Aluminum



Left: Frosted glass lens
Right: Silk-screen glass lens

PRODUCT SPECIFICATIONS

Summary	ADL-WUL-0301A
Lumen Output	250 lm
Power Consumption	3 W
Dimensions (mm)	Ø 64 x 94
Voltage	24V DC
Colour Temperature	3000k, 4000k, 5000k, Red, Green, Blue
IP	67
Warranty	5 years

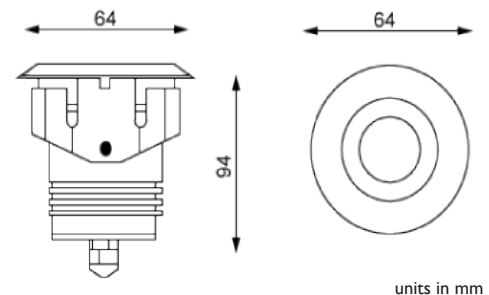

units in mm

ORDER FORM

ADL-WUL-0301A				
---------------	--	--	--	--

1	2	3	4
1. FAMILY	2. BEAM ANGLE	3. CCT	4. LENS OPTIONS
ADL-WUL-0301A	40 40° (standard) 20 20° 60 60°	30 3000K 40 4000K 50 5000K R Red G Green B Blue	1 Frosted glass lens 2 Silk-screen glass lens